

SINGLE GUIDE. INTEGRAL JAWS, CONCENTRIC CLAMPING, EQUIPPED WITH 1 SERIES CONSISTING OF 3 INTERNAL JAWS, 1 SERIES CONSISTING OF 3..

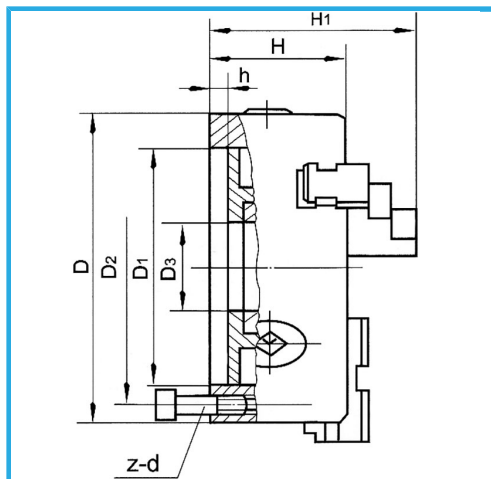

| | |
|----------------------|---------------|
| D1 | 106,375 mm |
| D2 | 133,4 mm |
| D3 | 80 mm |
| H1 | 142 mm |
| H | 98 mm |
| h | 16 mm |
| z-d | 6-M16 mm |
| Spanner square | 12 mm |
| A - A1 | 6 - 110 mm |
| B - B1 | 80 - 250 mm |
| C - C1 | 90 - 250 mm |
| Net weight | 32 kg |
| Gross weight | 34,00 kg |
| Packaging dimensions | - |
| EAN Code | 8012667397890 |



Box



Wooden Box



Cast Iron