

SINGLE GUIDE. INTEGRAL JAWS, CONCENTRIC CLAMPING, EQUIPPED WITH 1 SERIES CONSISTING OF 4 INTERNAL JAWS, 1 SERIES CONSISTING OF 4..

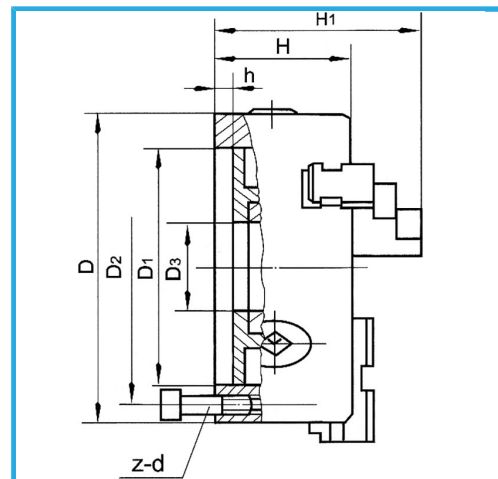

D1	95 mm
D2	108 mm
D3	30 mm
H1	84 mm
H	58 mm
h	4 mm
z-d	3-M8 mm
Spanner square	10 mm
A - A1	2,5 - 40 mm
B - B1	38 - 125 mm
C - C1	38 - 110 mm
Net weight	4,9 kg
Gross weight	5,30 kg
Packaging dimensions	180x180x165h mm
EAN Code	8012667398057

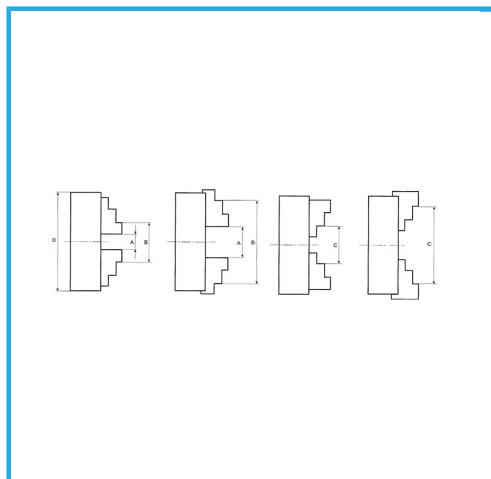

Box



Wooden Box



Cast Iron