

PROFESSIONAL SERIES. IN COMPOSITE MATERIAL, HANDLE AND HEAD IN SHOCKPROOF RUBBER. OPERATING LEVER, CHANGE OF ROTATION AND SPEED..

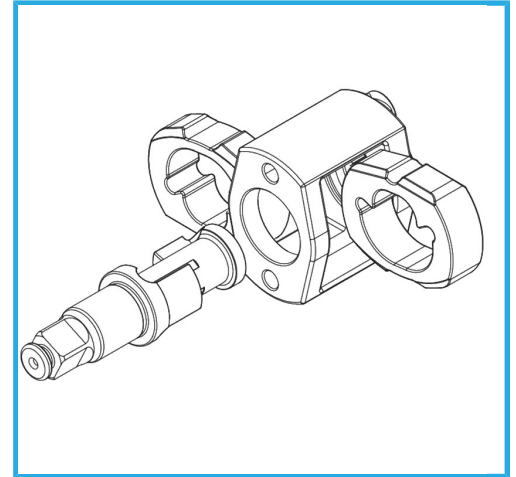

<b>Speed</b>	8500 rpm
<b>Torque</b>	542 Nm   400 lb-ft
<b>Avg air cons.</b>	108 l/min   3.8 SCFM
<b>Working pressure</b>	6 bar   90 psi
<b>Air inlet</b>	1/4"
<b>Net weight</b>	1,2 kg
<b>Packaging dimensions</b>	205 x 190 x 65 h mm
<b>Gross weight</b>	1,33 kg
<b>EAN Code</b>	8012667346270

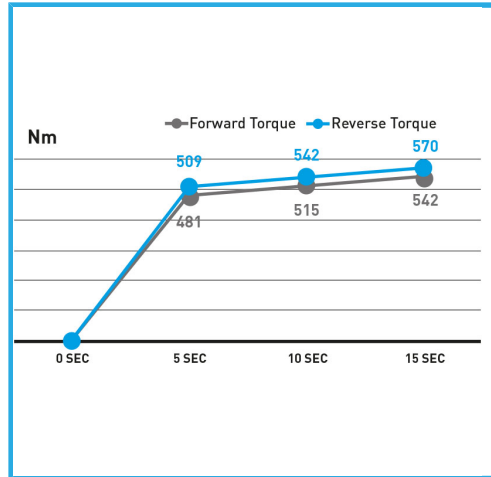

Box



3/8"